

MNI-HS



The **MNI-HS** is the high stable version of the MNI mirror mount. The MNI-HS can be used for applications where a high stability is necessary.

Features:

- Small high stable mirror mount
- 4 springs
- Open or closed back plate
- Different front plates available
- Stainless steel insert for stabilization
- M4 thread
- #8-32 thread available on request

Screw Options:

- Fine thread screws Model 1:
with **150 $\mu\text{m}/\text{turn}$ (170 TPI)**
with **100 $\mu\text{m}/\text{turn}$ (250 TPI)**
- Micrometer screws:
500 $\mu\text{m}/\text{turn}$ (50 TPI)
250 $\mu\text{m}/\text{turn}$ (100 TPI)
100 $\mu\text{m}/\text{turn}$ (250 TPI)

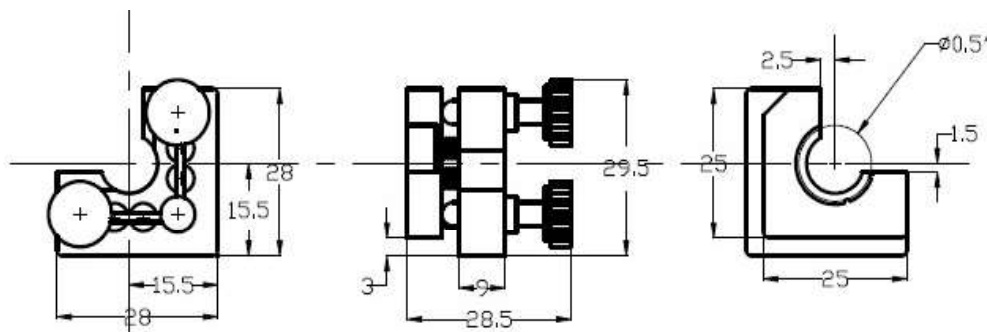

Mirror Mounts

Back plates

		<p><i>Due to strong spring forces we offer the MNI-H only with two alignment screws. If a third screw should be necessary, we recommend the screw as hexagon socket for easier alignment.</i></p>
MNI-HS-2-...	MNI-HS-2G-...	

Front plates

				
...-3000	...-3010 (6H7)	...-3021 (1/2")	...-3030 (1/2")	...-3025 (1")

The order number of the desired MNI-HS mirror holder consists of the number of the back plate including quantity of the screws and the number of the chosen front plate.

MNI-H-U

- Extra small mirror mount
- 4 strong springs
- High-precision screws with hexagon socket with M4 inner lowering
- Option: with locking device

MNI-H-U-2-3030
MNI-H-U-3-3030

